

# iPad Restrictions: Why You May Want to Use Them

iPad Restrictions allow us to have a degree of control over what content is accessible on the device. If we are dealing with division owned iPads and they are being loaned out to students, it is important to have some control over what they can be doing on them.

To access the **Restrictions**, launch **Settings** and select **General**. Scrolling down the screen you will see **Restrictions**.

The first time you enter the **Restrictions** area you will have to Enable them. Upon Enabling the restrictions, you will be required to set up and confirm a **passcode**. Do not use the same passcode that has been set for your locking screen as students will often know this code.

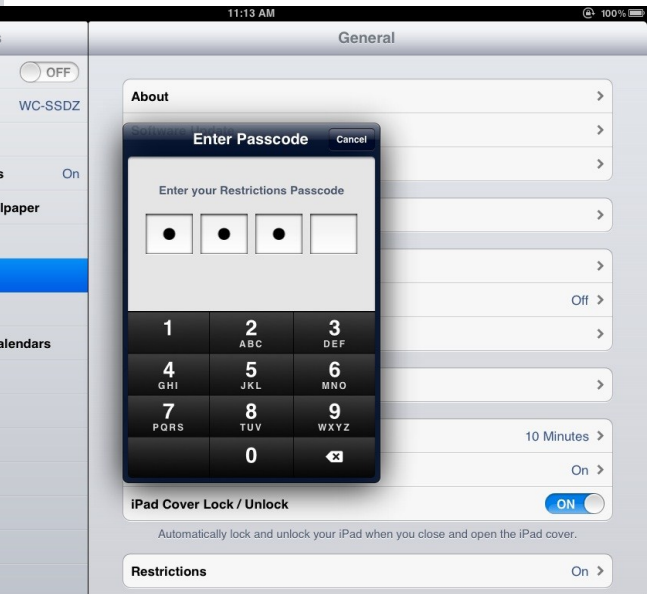
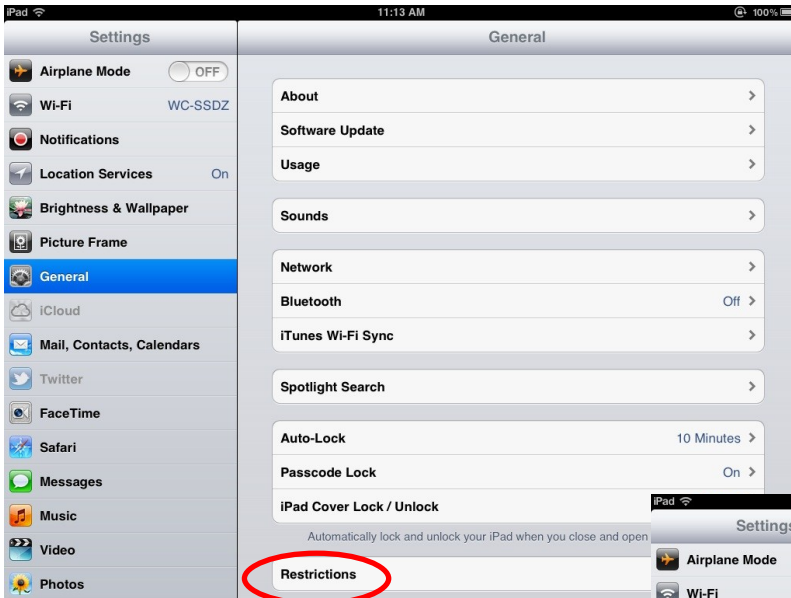

Do not forget this passage. It may be wise to record it in the file used to track APP purchases.

Once in the **Restrictions**, you will see different items that you can restrict. If you turn off an item it will not be removed from the iPad but will become inactive.



You can turn off **Safari** for access to internet browsing, **YouTube** for videos, options to **Install** and **Delete** Apps as well as many more options.

Some of the main reasons to use the **Restrictions** follow on the next page along with which items are recommended to be in the restricted category.

You may want to turn off **Safari** or **YouTube** if you find that students are continually getting sidetracked from using the Apps they were directed to for your lesson. What if they are snapping pictures of their classmates while they should be working? This may be the time to consider limiting certain students access to the iPads at all.



If you turn **OFF** the **Safari** App, it will no longer appear on the left hand side where you can access those settings.

You may want to do this for the ability to **install and delete apps** as some students might remove apps that may be crucial to your lesson. It is true that these apps can be reinstalled but this can take away from valuable class time.



Students can also install apps and use up your funds if you have not set the time correctly for how often the password needs to be entered when purchasing apps.

In the **Accounts** area, you want to select **Don't Allow Changes**. Without this restriction, students can sign in with their own Apple ID and sync to their collection of apps which can be a serious copyright violation.



Scroll down further in the **Restrictions** area and you will see options for the ability to modify **Allowed Content**.

Here you can set the ratings for all content including music, podcasts, movies, TV shows and Apps. You can also change how long your iPad will allow you to download Apps before asking for a password.

For a quick video tutorial on the **Restrictions** for the iPad, check out this YouTube link.

[http://www.youtube.com/watch?v=DpUB7-0NFU&safety\\_mode=true&persist\\_safety\\_mode=1&safe=active](http://www.youtube.com/watch?v=DpUB7-0NFU&safety_mode=true&persist_safety_mode=1&safe=active)